

L70  
25°C

147,000 Hours

NOTES:

FIXTURE TYPE:

PROJECT:

## FEATURES

**Housing:**

Extruded Aluminum Housing with Flush Mounting Base & Vandal-Resistant Screws, Domed Top, Internal Ballast Tray for Easy Maintenance. Bollards Can Be Cut to Custom Lengths Upon Request.

**Listing & Ratings:**

CSA: Listed for Wet Locations, ANSI/UL 1598, 8750; IP65 Sealed LED Compartment.

**Finish:**

Textured Architectural Bronze or Black Powdercoat Finish Over a Chromate Conversion Coating. Custom Colors Available Upon Request.

**Style:**

Clear Prismatic Borosilicate Glass Refractor, Specially Designed Cone Reflector or Internal Louvers

**Lens:**

Clear UV-Stabilized Polycarbonate Vandal-Resistant Lens or SoftLED LumaLens UV-Stabilized Polycarbonate Opal Vandal-Resistant Lens

**Mounting Options:**

Mounting Kit with 8 Zinc-Plated Anchor Bolts, Included.

**EasyLED LED:**

Aluminum Boards

**Wattage:**

Array: 10w, System: 11.3w; (70w HID Equivalent)  
Array: 14.5w, System: 17w; (70w HID Equivalent)  
Array: 22w, System: 23.8w; (70w HID Equivalent)

**Driver:**

Electronic Driver, 120-277V, 50/60Hz or 347V, 50/60Hz (15w Only); Less Than 20% THD and PF>0.90. Standard Internal Surge Protection 2kV. 0-10V Dimming Standard for a Dimming Range of 100% to 10%; Dimming Source Current is 150 Microamps.

**Controls:**

Fixtures Ordered with Factory-Installed Motion Sensor Controls are Internally Wired for Switching and/or 1-10V Dimming Within the Housing. Remote Direct Wired Interface of 1-10V Dimming is Not Implied and May Not Be Available, Please Consult Factory. Fixtures are Tested with LEPC Controls and May Not Function Properly With Controls Supplied By Others. Fixtures are NOT Designed for Use with Line Voltage Dimmers.

**Warranty:**

5-Year Warranty for -40°C to +40°C Environment.  
See Page 2 for Projected Lumen Maintenance Table.

## DIMENSIONS

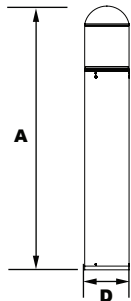

## DIMENSIONS

<b>Diameter (D)</b>	7" (178mm)
<b>Height (A)</b>	42 1/4" (1,073mm)

## PRODUCT DESCRIPTION

The EasyLED Bollards with choice of optics and lenses and lenses are designed to replace HID lighting systems up to 70w MH or HPS. These fixtures are ideal for retail centers, industrial parks, schools and universities, public transit and airports, office buildings and medical facilities.

## ORDERING INFORMATION

EXAMPLE: BORLQF1X22U5KZ36SF



Model	Optics	Wattage	Driver	CCT	Lens	Color	Height	Options
<b>BOGQ</b> =Round Dome Bollard with Glass <b>BORLQ</b> =Round Dome Bollard with LED Cone Reflector <b>BORWQ</b> =Round Dome Bollard with White LED Cone Reflector <b>BOLQ</b> =Round Dome Bollard with Louvers	<b>C</b> =Type III* <b>F</b> =Wide Beam Spread  *BOGQ, BORLQ and BORWQ only	<b>1X10</b> =10w <b>1X15</b> =15w <b>1X22</b> =22w	<b>U</b> =120-277V <b>C</b> =347V*  *15w Model Only	<b>3K</b> =3000K <b>4K</b> =4000K <b>5K</b> =5000K	<b>(Leave Blank)</b> = Clear Lens <b>L</b> =SoftLED LumaLens Opal UV-Stabilized Polycarbonate Array Lens*  *Type V White Cone Reflector Only	<b>Z</b> =Bronze <b>B</b> =Black <b>C</b> =Custom (Consult Factory)	<b>(Leave Blank)</b> = 42" Standard Height <b>36</b> =36" Height <b>30</b> =30" Height	<b>SF</b> =Single Fuse* <b>DF</b> =Double Fuse* <b>SP</b> =Surge Protection <b>GF1</b> =GFCI Outlet, 15A, 120V <b>GSB</b> =180° Glare Shield, Black <b>GSZ</b> =180° Glare Shield, Bronze <b>GSC</b> =180° Glare Shield, Custom Color (Consult Factory) <b>S3</b> =Microwave Sensor with Dimming & Remote Programming, 120-277V Only. See P17121 Spec. Page for Details. <b>BU</b> =Battery Backup, 90 Minutes*  *120-277V Models Only.

## ACCESSORIES &amp; REPLACEMENT PARTS

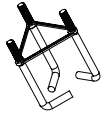
**BOLAN****BREBASE\*****P17122****P17121****BOLPC,  
BOLPCLL****BORBASE\*****BOADP1**

\*Shown Mounted

**Mounting Accessories  
(Order Separately, Field Installed)****BOLAN4** Mounting Kit, Includes Bracket & Three (3) 4" Zinc-Plated Anchor Bolts**BOLAN8** Mounting Kit, Includes Bracket & Three (3) 8" Zinc-Plated Anchor Bolts**BOLAN12** Mounting Kit, Includes Bracket & Three (3) 12" Zinc-Plated Anchor Bolts**BOLAN15** Mounting Kit, Includes Bracket & Three (3) 15" Zinc-Plated Anchor Bolts**BREBASE\*** Bollard Retrofit Base Kit Adapts New Bollards to Most Existing Bolt Patterns. Fits all LEPG Bollards. Die Cast with Powdercoat Finish, Hardware Included. 11½" Dia. x 1½" H

\*Specify Color: Z=Bronze, B=Black, C=Custom (Consult Factory)

**Accessories  
(Order Separately, Field Installed)****P17122** Remote Programming Tool for P17121**Replacement Parts  
(Order Separately, Field Installed)****P17121** Internal Microwave Sensor with Dimming & Remote Programming, 120-277V Only. See P17121 Spec. Page for Details.**BOLPC** Replacement Round UV-Stabilized Polycarbonate Vandal-Resistant Lens**BOLPCLL** Replacement SoftLED LumaLens Opal UV-Stabilized Polycarbonate Array Lens**BORBASE\*** Die Cast Base Plate with Powdercoat Finish Over a Chromate Conversion Coating.**BOADP1** Adapter Plate with Gaskets for Outlet Boxes. Fits LEPG Round Bollards. Die Cast with Bronze Powdercoat Finish.

\*Specify Color: Z=Bronze, B=Black, C=Custom (Consult Factory)

For Replacement Battery Backup, see the LEPG LED Battery Backup Specification Sheet.

## PHOTOMETRIC DATA

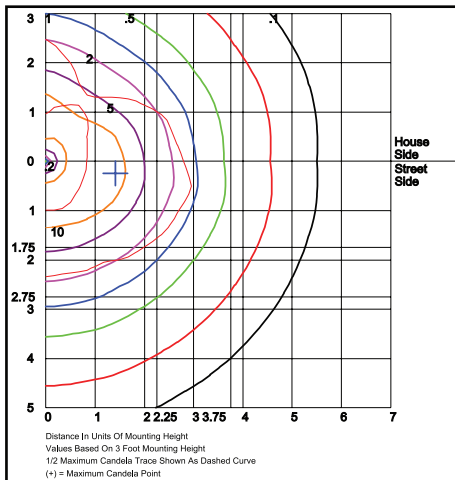
**BOGQC1X22U5K****Type III**

Grid in feet, Mounting Height = 3 ft.

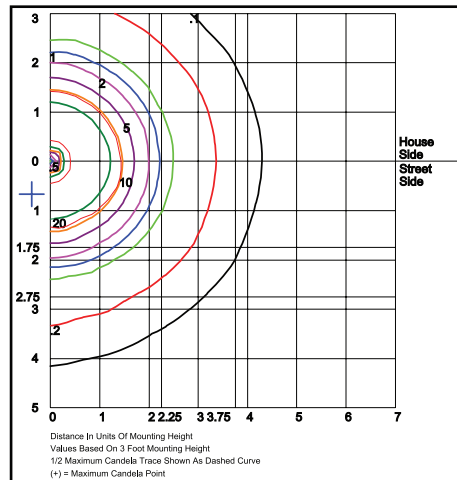
**BORLQF1X22U5K & BORWQF1X22U5K****Type V**

Grid in feet, Mounting Height = 3 ft.

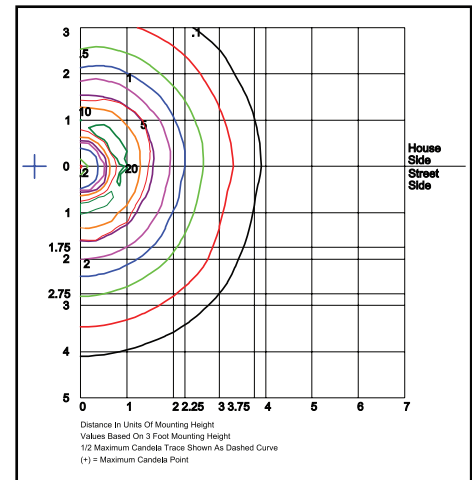
**BOLQF1X22U5K****Type V**

Grid in feet, Mounting Height = 3 ft.

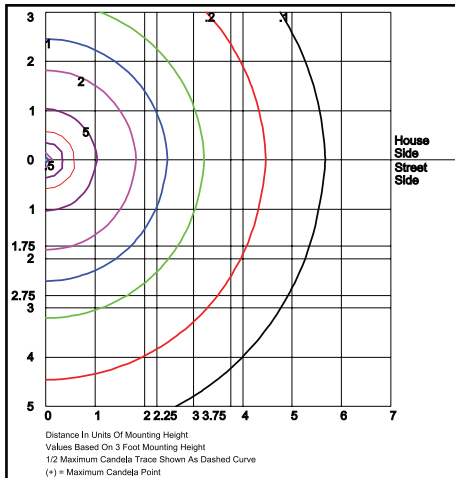
**BORWQF1X22U5KL, LumaLens****Type V**

Grid in feet, Mounting Height = 3 ft.

## PHOTOMETRIC PERFORMANCE

Wattage (Catalog Logic)		10W (1X22)	15W (1X15)	20W (1X22)
Input Watts		11.3W	15.9W	23.8W
Optic	CCT	Delivered Lumens		
<b>BOGQ Glass C=Type III Optic</b>	3000K	789	1,105	1,657
	4000K	856	1,199	1,798
	5000K	892	1,249	1,873
	BUG Rating	B1-U3-G1	B1-U3-G1	B1-U3-G1
<b>BOGQ Glass F=Type V Optic</b>	3000K	773	1,082	1,622
	4000K	838	1,173	1,760
	5000K	873	1,222	1,833
	BUG Rating	B1-U3-G1	B1-U3-G1	B1-U3-G1
<b>BOLQ Louvers F=Type V Optic Only</b>	3000K	521	730	1,094
	4000K	565	791	1,187
	5000K	589	824	1,236
	BUG Rating	B0-U2-G0	B1-U2-G1	B1-U3-G1
<b>BORLQ &amp; BORWQ Cone Reflector C=Type III Optic</b>	3000K	738	1,033	1,549
	4000K	800	1,120	1,680
	5000K	834	1,167	1,750
	BUG Rating	B0-U2-G1	B1-U3-G1	B1-U3-G1
<b>BORLQ &amp; BORWQ Cone Reflector F=Type V Optic</b>	3000K	1,031	1,444	2,165
	4000K	1,119	1,566	2,349
	5000K	1,165	1,631	2,447
	BUG Rating	B1-U3-G1	B1-U3-G1	B1-U3-G1

## PROJECTED LUMEN MAINTENANCE

Data shown for 5000 CCT			Compare to MH			
TM-21-11	Input Watts	Initial	25,000 Hrs	50,000 Hrs	100,000 Hrs	Calculated LED Life
<b>L70 Lumen Maintenance @ 25°C / 77°F</b>	All wattages up to and including 24w	1.00	0.95	0.90	0.80	147,000
<b>L70 Lumen Maintenance @ 50°C / 122°F</b>		1.00	0.89	0.78	0.55	67,000
<b>L80 Lumen Maintenance @ 40°C / 104°F</b>		1.00	0.92	0.85	0.70	66,000

## NOTES:

1. Projected per IESNA TM-21-11. Data references the extrapolated performance projections for the 116mA base model in a 25°C ambient, based on 10,000 hours of LED testing per IESNA LM-80-08.
2. Compare to MH box indicates suggested Light Loss Factor (LLF) to be used when comparing to Metal Halide (MH) systems.