

L70  
25° C

72,000 Hours



## SPECIFICATIONS

## Construction:

- Slim/sleek die-cast aluminum housing with stainless steel hardware and powder coat finish
- Integral heat sink fins maximize heat dissipation
- Hinged driver access door for ease of maintenance
- Universal adjustable arm included standard that can be mounted to 4" or 5" round or square poles, slipfit over a 2-3/8" tenon or be wall-mounted
- Includes (2) 6' conductor whips (3 conductor for building power supply and 2 conductor for dimming leads)

## Optics/LEDs:

- 100 to 300 Watts with field-switchable lumen packages from 14,500 to 48,000 lumens
- Designed with zero uplight to eliminate light pollution
- Efficiencies up to 160 LPW maximize energy savings and utility rebates
- Field-switchable distribution between Type III, IV and V to optimize light distribution
- Field-switchable CCT between 3000K, 4000K and 5000K
- L70 ≥ 72,000 hours \ L90 ≥ 65,000 hours
- CRI >80

## Electrical:

- Class 1 power supply, 120-277VAC, 50/60Hz
- 0-10V Dimming driver
- Power Factor ≥ 0.90
- 277-480VAC Dedicated driver option
- 10KA(@120-277V) or 20KA(@277-480V) Surge protection
- 3.5mm AUX jack for sensor

## Installation:

- Hinged driver door for ease of access (coin plugs on the driver door provides ease of access to dipswitches for power, CCT and distribution selectability)
- Standard universal adjustable arm included that can be mounted to 4" or 5" round or square poles, 3" slipfitter to fit over 2-3/8" tenon or be wall-mounted

## PRODUCT DESCRIPTION

The ALSW Series universal switchable area luminaire offers performance and durability with a sleek one-piece die-cast aluminum and high efficacy of up to 160 lumens per watt. It not only features field switchable power (14,500 to 49,000 lumens) and CCT (3000K-4000K-5000K) it also allows for field switchable distributions between Type III, IV, and V to cater to diverse lighting needs while maintaining zero uplight to eliminate light pollution.

The ALSW provides incredible versatility with its control capabilities (built-in aux receptacle) and includes an adjustable universal arm in the box that can be mounted to 4" or 5" round or square poles, slipfit over a 2-3/8" tenon or be wall-mounted. To further enhance project flexibility, we also offer several other options and accessories, including shields, mounts and 480V capability. The ALSW Series is an excellent lighting solution for a wide range of outdoor applications such as parking lots, pathways, and building facades.

## ORDERING INFORMATION



Series <sup>1</sup>	Wattage	Distribution	Input Voltage	CCT	Finish	Mount
LX-PKS151 = 15' Pole, 1 Head LX-PKS152 = 15' Pole, 2 Head LX-PKS153 = 15' Pole, 3 Head LX-PKS154 = 15' Pole, 4 Head LX-PKS201 = 20' Pole, 1 Head LX-PKS202 = 20' Pole, 2 Head LX-PKS203 = 20' Pole, 3 Head LX-PKS204 = 20' Pole, 4 Head LX-PKS251 = 25' Pole, 1 Head LX-PKS252 = 25' Pole, 2 Head LX-PKS253 = 25' Pole, 3 Head LX-PKS254 = 25' Pole, 4 Head LX-PKS301 = 30' Pole, 1 Head LX-PKS302 = 30' Pole, 2 Head LX-PKS303 = 30' Pole, 3 Head LX-PKS304 = 30' Pole, 4 Head	150 = 100-150W 300 = 200-300W	SD = T3/T4/T5 Switchable	HVS = 277-480VAC VS = 120-277VAC	CP = CCT & Power Switchable	BR = Bronze XX = Other Finishes	U = Universal Mount
<b>Options (Factory Installed)</b> PC3 = 3-Pin Twist Lock Receptacle PC7 = 7-Pin Twist Lock Receptacle						
<b>Anchor Kit<sup>3</sup> (Mandatory Selection - Order as Separate Line Item)</b> LX-PKS20-ANCKIT = 15' & 20' Pole Anchor Kit (4) 3/4" x 17" x 3" Anchor Bolts, (2) Nuts and Washers per bolt, (1) Template - 9.5" BC LX-PKS25-ANCKIT = 25' Pole Anchor Kit (4) 3/4" x 30" x 3" Anchor Bolts, (2) Nuts and Washers per bolt, (1) Template - 9.5" BC LX-PKS30-ANCKIT = 30' Pole Anchor Kit (4) 1" x 36" x 4" Anchor Bolts, (2) Nuts and Washers per bolt, (1) Template - 11.3" BC						
<b>Accessories<sup>4</sup> (Field Installed)</b> LE-MS3W-BL-AUX-HR1 = Bluetooth PIR Motion Sensor with Photocontrol, Black LX-MSP12-BL = Dimming Occupancy Sensor, PIR, Black Finish LX-MSSW-REMOTE = Remote for Sensor LXPR = 120-277VAC 3-Pin Twist Lock Photocontrol and Receptacle LXPR7 = 120-277VAC 7-Pin Twist Lock Photocontrol and Receptacle LXPRH = 347-480VAC 3-Pin Twist Lock Photocontrol and Receptacle LXSC = 3-Pin Shorting Cap						
<b>Notes</b> <sup>1</sup> Fixture and pole shipped separately <sup>2</sup> Not available with HVS option <sup>3</sup> Order as separate line item, requires one (1) per pole ordered <sup>4</sup> Order as separate line item						

ORDERING EXAMPLE: LX-PKS252-300-SD-VS-CP-BR-U + LX-PKS25-ANCKIT

## SPECIFICATIONS

## Options:

- 3-Pin Twist Lock receptacle (Option PC3)
- 7-Pin Twist Lock receptacle (Option PC7)

## Field Installed Accessories:

- 3-Pin Twist Lock universal photocontrol (120-277VAC) for dusk to dawn lighting control (TLPR)
- 7-Pin Twist Lock universal photocontrol (120-277VAC) for dusk to dawn lighting control (TLPR7)
- 3-Pin Twist Lock universal photocontrol (347-480VAC) for dusk to dawn lighting control (TLPRH)
- Bluetooth enabled dimming occupancy sensor (LE-MS3W-BL-AUX-HB1), PIR, 120/277VAC
- Dimming occupancy sensor (TL-MSP12-BL), PIR, with photocontrol, 120/277VAC
- Multiple contractor friendly accessories available, see ordering information
- 3-Pin Shorting Cap (TLSC)

## Testing &amp; Compliance:

- cULus Listed for Wet Locations, tested to meet IP65 requirements
- DesignLights Consortium® (DLC) PREMIUM Qualified (consult QPL for qualified models)
- Operating temperature: -40°C to 50°C (-40°F to 122°F)
- 3G Vibration rated enclosure

## Warranty:

- Five Year Warranty (Terms and Conditions Apply)
- 10 Year Warranty available upon request

## POLE SPECIFICATIONS

## Pole Shaft:

- 4.0" (15', 20' & 25') and 5.0" (30') Square non-tapered steel pole
- One piece construction fabricated from a weldable grade carbon steel structural tubing which has a uniform wall thickness of 11 gauge (0.1196") in the LX-PKS15X, LX-PKS20X and LX-PKS25X models and 7 gauge (0.1793") in the LX-PKS30X series
- Pole shaft material shall conform to ASTM A-500 Grade C with a minimum yield of 42,000 psi
- Shaft has a full length longitudinal resistance weld
- Uniformly square cross-section with flat sides, small corner radii and excellent torsional properties

## Base Plate:

- Includes 2-piece ABS plastic cover is easily assembled and securely attached

## Hand Hole:

- A rectangular reinforced gasketed handhole, having a nominal 3" x 5" inside opening, located 18" from the base, is standard on all poles
- A grounding provision is located inside the handhold ring

## Anchor Bolt:

- Fabricated from commercial quality hot rolled carbon steel bar that meets or exceeds a minimum yield strength of 42,000 psi
- Four properly sized anchor bolts, each with two regular hex nuts and washers, are furnished and shipped with all poles unless otherwise specified
- Anchor bolts shall have the threaded end galvanized a minimum of 8" in accordance with ASTM A-153
- Anchor bolts and template shipped with pole - Note on PO if needs to ship early

## Fixture Mounting:

- All poles come pre-drilled and capped on all four sides to meet desired mounting

## Finish:

- Standard - All exterior metal surfaces are mechanically cleaned to remove all oxides and contaminants prior to coating
- Standard finish is a polyester thermosetting powder coating applied to the surface of the substrate to a minimum of 3 mils for all color finishes

## SPECS AT A GLANCE

Model	ALSW -150	ALSW -300
Wattage*	100W-120W-150W (Switchable)	200W-240W-300W (Switchable)
Lumens (lm)	14,500 - 24,000	29,000 - 48,000
Efficacy (LPW)	up to 160	
Distribution	Type 3, 4, 5 (Switchable)	
CCT (K)	3000K-4000K-5000K (Switchable)	
CRI	>80	
Input Voltage	120-277VAC or 277-480VAC	
Operating Temp	-40°C to 50°C (-40°F to 122°F)	
Certifications	UL Listed for Wet Locations, IP65, DLC PREMIUM	
Warranty	5 Years	
Weight	10.6 lbs	14.4 lbs

\* Nominal Wattage, tested at 4000K CCT. See performance table for details.

Note: Environment and application will affect actual performance. Typical values and 25°C (77°F) used for testing. Specifications subject to change without notice.

## POLE SPECS AT A GLANCE

Nominal Height	15.0'	20.0'	25.0'	30.0'
Diameter	4.0"	4.0"	4.0"	5.0"
Gauge	11 GA	11 GA	11 GA	7 GA
Handhole Size	3.0" x 5.0"			
Anchor Bolt	.75" x 17" x 3"	.75" x 17" x 3"	.75" x 30" x 3"	1" x 36" x 4"
Bolt Circle Range	8" - 11"	8" - 11"	8" - 11"	10.6" - 12"
Bolt Circle	9.5"	9.5"	9.5"	11.3"
Max EPA (ft.2): 80 MPH	17.9	9.6	5	10.7
Max EPA (ft.2): 90 MPH	13.5	6.7	2.6	6.7
Max EPA (ft.2): 100 MPH	10.3	4.5	1	3.9
Weight	113 lbs	138 lbs	170 lbs	380 lbs
Warranty	1 Year			

## Notes:

1. Please verify wind load ratings at project location to determine if EPA meets local code.
2. LEDalux is not responsible for pole foundation design.
3. Freight allowed on all orders exceeding (5) 15-foot poles, (5) 20-foot poles, (4) 25-foot poles or (3) 30-foot poles.
4. Consult factory in areas where wind loading exceeds 100 mph.

### SAMPLE PHOTOMETRY

ALSW-150-SD345-VS-C P (150W, 4000K, T3)  
IES: TYPE III  
MOUNTING HEIGHT: 20'  
TILT: ZERO

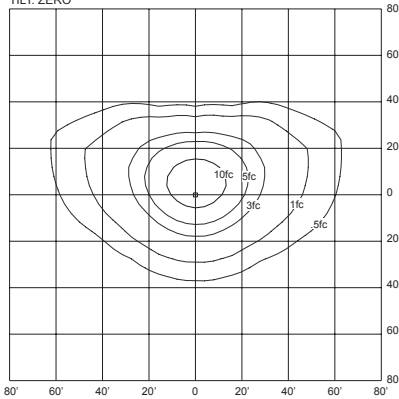

ALSW-150-SD345-VS-C P (150W, 4000K, T4)  
IES: TYPE IV  
MOUNTING HEIGHT: 20'  
TILT: ZERO

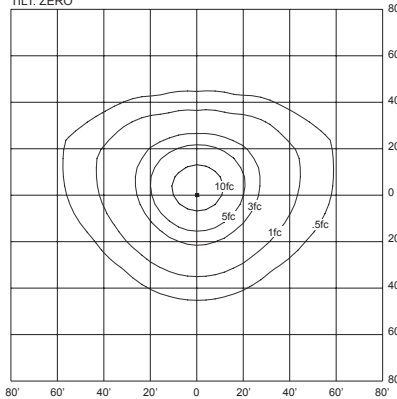

ALSW-150-SD345-VS-C P (150W, 4000K, T5)  
IES: TYPE V  
MOUNTING HEIGHT: 20'  
TILT: ZERO

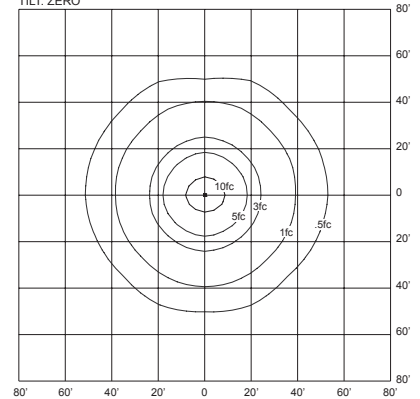

### DIMENSIONS

#### DIMENSIONS (150W)

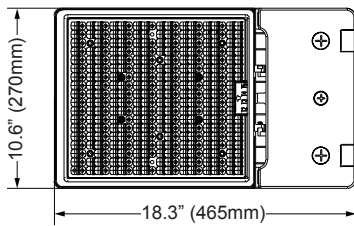

#### DIMENSIONS (300W)

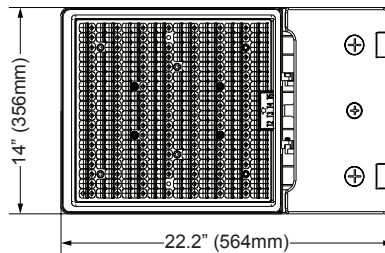

### EPA VALUES

<b>Model</b>	1	2 @ 90°	2 @ 180°	3 @ 90°	4 @ 90°
<b>150W</b>	1.4	1.77	2.94	2.94	4.26
<b>300W</b>	1.62	2.08	3.38	3.38	3.38

#### Pole EPA Values (See Page 2 for Additional Pole Information)

<b>Pole Height (ft)</b>	15	20	25	30
<b>Max EPA (ft.2): 80 MPH</b>	17.9	9.6	5	10.7
<b>Max EPA (ft.2): 90 MPH</b>	13.5	6.7	2.6	6.7
<b>Max EPA (ft.2): 100 MPH</b>	10.3	4.5	1	3.9

**NOTE:** Any pole accessories added in the field (such as banner or flag brackets) will affect published EPA values and may void factory warranties.

## BASE PLATE DETAILS

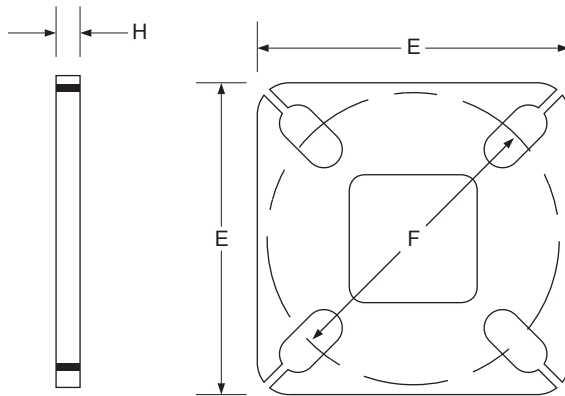

Anchor Base Size	Wall Thickness (H)	Base Plate (E)	Bolt Circle Range	Bolt Circle (F)	Bolt Projection
4"	0.75"	10.5"	8" - 11"	9.5"	3.75"
5"	1.0"	11.0"	10.6" - 12"	11.3"	4.875"

## DRILLING TEMPLATE (Std Mount)

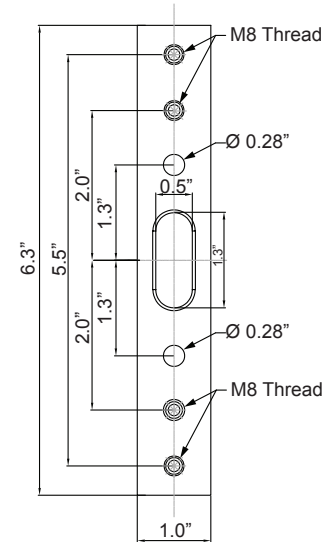

## ANCHOR BOLT TEMPLATES

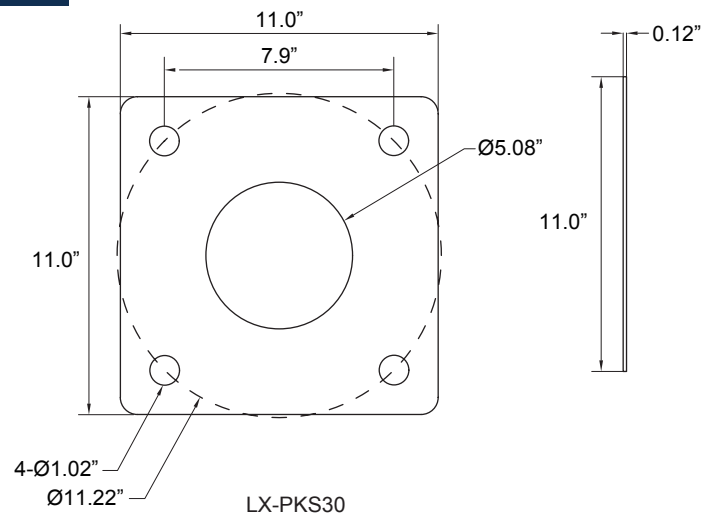
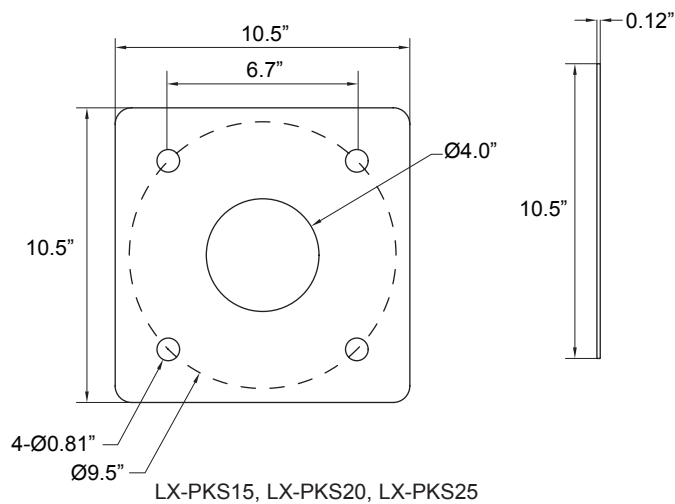

## ANCHOR BOLT DETAILS

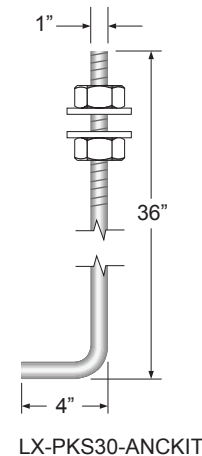
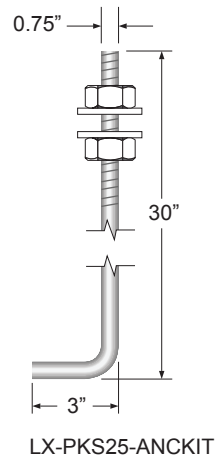
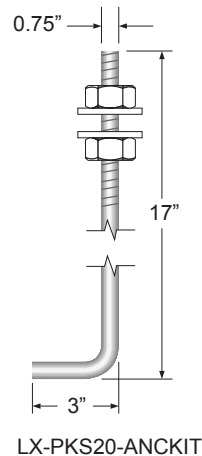

### SENSOR DETAILS - BLUETOOTH ENABLED (Accessory LE-MS3W-AUX-HB1)



LE-MS3W-BL-AUX-HB1

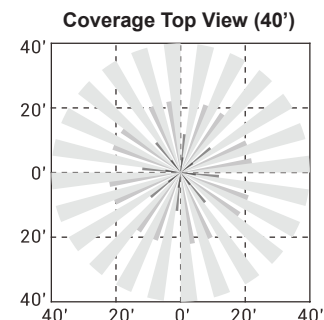
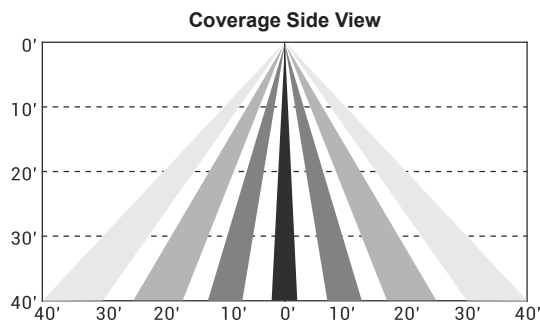

### SENSOR DETAILS (Accessories LX-MSP12-BL and LX-MSSW-REMOTE)



TL-MSP12-BL

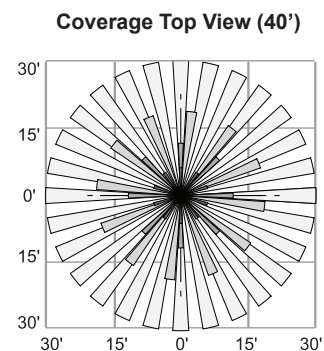
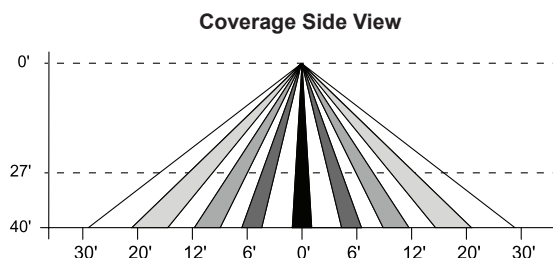

### SENSOR SETTINGS (LX-MSSW-REMOTE)

DETECTION RADIUS/ANGLE	MAX 60'/360°
MOUNTING HEIGHT	MAX 40'
REMOTE RANGE	MAX 33'
FREQUENCY	5.8 GHz
HIGH MODE	70%, 80%, 90%, 100% (DEFAULT 100%)
SENSITIVITY	20%, 50%, 75%, 100% (DEFAULT 100%)
HOLD TIME	10sec, 1min, 5min, 10min, 15min, 20min, 30min, 60min (DEFAULT 5min)
DAYLIGHT HARVESTING	10Lux, 30Lux, 50Lux, 100Lux, 300Lux, 500Lux (DEFAULT disabled)
STANDBY DIM SETTING	0%, 10%, 30%, 50% (DEFAULT 30%)
STANDBY TIME SETTING (TO OFF)	1min, 30min, 60min (DEFAULT 30min)



LX-MSSW-REMOTE  
(Sold Separately)

**UL AND DLC NOMENCLATURE FOR FIXTURE ONLY**

(ALSW fixture is UL Listed and Appears on the DesignLights Consortium® PREMIUM Qualified Product List)

Series	Wattage	Distribution	Input Voltage	CCT	Finish	Mount
ALSW	150 = 100-150W 300 = 200-300W	SD345 = T3/T4/T5 Switchable	HVS = 277-480VAC VS = 120-277VAC	CP = CCT & Power Switchable	BR = Bronze	U = Universal Mount
					XX = Other Finishes	
					Accessories <sup>2</sup> (Field Installed - Order As Separate Line Item)  <a href="#">LE-MS3W-BL-AUX-HB1</a> = Bluetooth PIR Motion Sensor with Photocontrol, Black LX-MSP12-BL = Dimming Occupancy Sensor, PIR, Black Finish LX-MSSW-REMOTE = Remote for Sensor LXPR = 120-277VAC 3-Pin Twist Lock Photocontrol LXPR7 = 120-277VAC 7-Pin Twist Lock Photocontrol LXPRH = 347-480VAC 3-Pin Twist Lock Photocontrol LXSC = 3-Pin Shorting Cap	
Options (Factory Installed) PC3 = 3-Pin Twist Lock Receptacle PC7 <sup>1</sup> = 7-Pin Twist Lock Receptacle						
Notes  <sup>1</sup> Not available with HVS option  <sup>2</sup> Order as separate line item - Shipped in separate box for final installation in the field				Accessories <sup>2</sup> (Field installed, order as separate line item)  ALSW-GS1-XX = Glare Shield, Up to 150W (XX = BL; Black, BR; Bronze, SV; Gray Alum, WH; White) ALSW-GS2-XX = Glare Shield, 200 to 300W (XX = BL; Black, BR; Bronze, SV; Gray Alum, WH; White) ALSW-FM1-XX = Flood Mount, Up to 150W (XX = BL; Black, BR; Bronze, SV; Gray Alum, WH; White) ALSW-FM2-XX = Flood Mount, 200 to 300W (XX = BL; Black, BR; Bronze, SV; Gray Alum, WH; White)		